

*This Year's Symposium is Sponsored by the Department
of Anthropology, Arizona State University
and Dedicated to the Spirit of Emil W. Haury, Pioneer
Researcher, Mentor*

**Education
Lecture
Hall
(ADC-117)**

Southwest Symposium

**Arizona
State
University**

January 15 and 16, 1988

Friday, January 15, 1988

9:00am-10:00am

Registration and Coffee

10:15am-12:30pm

Hunters and Gatherers

Katherine Spielmann,
Organizer

*Thermal Maxima and Episodic Occupation
of the Picacho Reservoir Dune Field*

Frank Bayham
and Donald Morris

*An Overview of Hunter-Gatherer Archaeology
in the Four Corners Area*

William Parry and
F. E. Smiley

*Prospects for the Study of Hunter-Gatherers
in the Southwest*

John Speth

*Archaic Hunter-Gatherer Archaeology in
Northwestern New Mexico*

Brad Vierra

Sonoran Island Archaeology

Elisa Villalpando C.

Discussant

Cynthia Irwin-Williams

Lunch Break

2:00pm-4:30pm

Transitions to Sedentism

Patricia A. Gilman and
Michael E. Whalen,
Organizers

*Sedentism or Mobility: What Do
the Data Say? What Did the Anasazi Do?*

Shirley Powell

*Site Occupation, Duration, and
Patterns of Sedentism among
the Eastern Anasazi*

Sarah H. Schlanger

*Agricultural Dependence and Settlement
Pattern in the Mountain Mogollon Region*

Robert J. Hard

*Patterns of Residential Mobility and
Sedentism in the Jornada Mogollon
Region*

David Carmichael

*Settlement and Residence in Southern
Arizona Prior to the Classic Period*

Paul R. Fish,
Suzanne K. Fish and
John Madsen

Discussants

George J. Gumerman
Margaret C. Nelson
and Ben A. Nelson

5:00pm-7:00pm

Reception and Light Buffet Museum of Anthropology ASU

7:15pm-9:30pm

History of Intellectual Transitions

J. Jefferson Reid,
Organizer

*Myths to Methods: Intellectual Transitions
in Flagstaff Archaeology*

Christian E. Downum

*Population Growth and Mobility in Southern
Colorado Plateau Archaeology*

Andrew L. Christenson

*Cultivating Ideas: The Changing Perceptions on
the Introduction of Agriculture to the Southwest*

Wirt H. Wills

*Sedentism and Aggregation in South-
West Archaeology*

Stephen H. Lekson

Saturday, January 16, 1988

9:00am-12:00pm

Elites and Regional Systems

Randall McGuire,
Organizer

*Observations on the Elites of the Pimeria
and Opateria in Prehispanic Times*

Beatriz Braniff

*Elites in Southwestern Prehistory: The
Evidence and Lack Thereof*

Fred Plog

*The Complex and the Complicated: Obser-
vations on the Nature of Archaeological
Data*

Stephanie M. Whittlesey
J. Jefferson Reid

*Monumental Efforts without elites:
the preclassic Hohokams*

Glen Rice

*Explanations of Population Aggregation
in the Mesa Verde Region Prior to
A. D. 900*

Janet D. Orcutt
Eric Blinman
Timothy A. Kohler

*Elite Formation and Interregional
Exchange in Peripheries*

Richard Pailes

Discussants

William Lipe
James Judge

Saturday, January 16, 1988

Lunch Break

1:30pm-4:00pm

Prehistoric to Historic Transitions

William Doelle,
Organizer

*Patterns and Process in Eastern Pueblo
Development: A.D. 1200-1700*

David Snow

*Protohistoric Transitions in the Western
Pueblo Area*

Keith Kintigh

*Old World Diseases in the Protohistoric
Period*

Henry Wallace
and William Doelle

*Continuity and Change in the Proto-
historic Southwest*

Dan Reff

The Transition to History in Pimeria Alta

Carroll Riley

Discussants

David Wilcox
Henry Dobyns

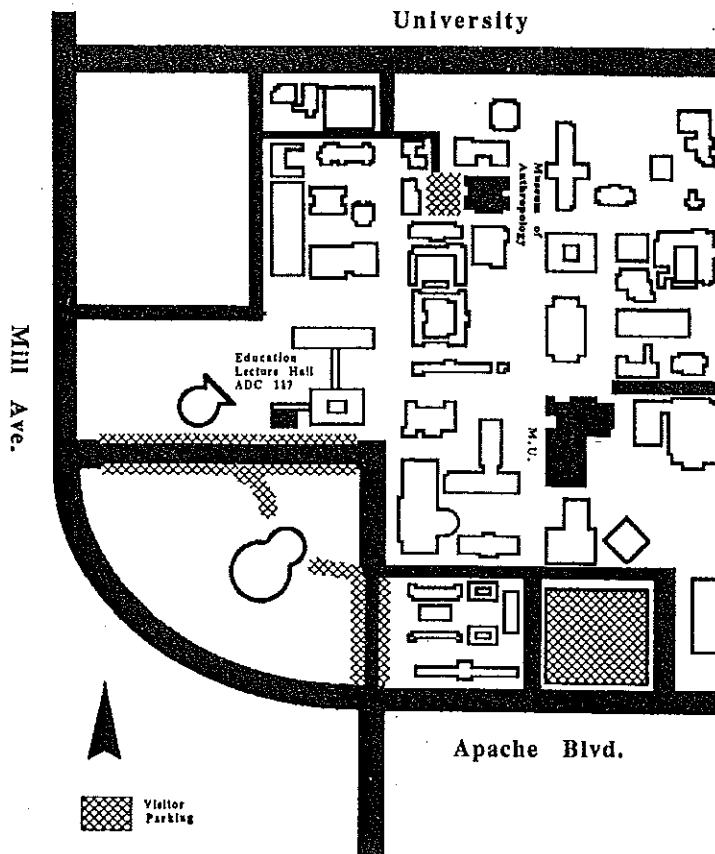

Conference Co-organizers
Paul E. Minnis
Charles L. Redman

Designed by Lael Weston
Graphic Design Department
Arizona State University